

SCHEDULE 40 PVC

PVC 40 conduits are manufactured with rigid polyvinyl chloride compound (PVC-U) according to specifications of the UL Standard - 651 and ASTM - D1784.

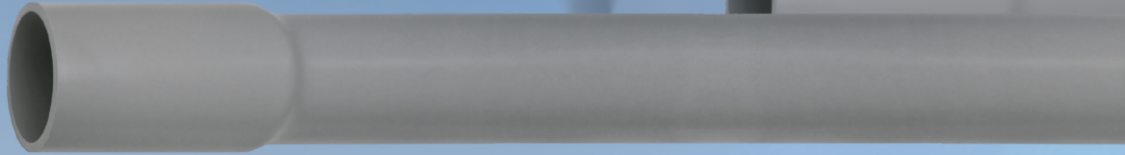

Heavy Duty Solar Light
 Certified for underground and aerial use For direct underground and coated
 underground use Rigid non-metallic conduit for electrical wiring and wires
 Lengths of 10* (3 Mt)
 Length of 20* (6 Mt) on request.

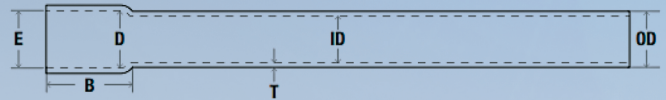

PVC CONDUIT SCH 40 - DATOS TECNICOS EN PULGADAS (in)

COMMERCIAL SIZE OF THE TUBE (In)	METRIC DESIGNATION (mm)	EXTERNAL DIAMETER AVERAGE (OD)	INTERNAL DIAMETER AVERAGE (ID)	THICKNESS MINIMUM WALL SCH40 (T)	DIAMETER ENTRANCE BELL AVERAGE (E)	DIAMETER BACKGROUND BELL AVERAGE (D)	LONGITUD MINIMA DE CAMPANA (B)	LENGTH OF THE TUBE (ft)
½"	16	0.840	0.578	0.109	0.852	0.836	1.77	10
¾"	21	1.050	0.780	0.113	1.064	1.046	2.16	10
1"	27	1.315	1.004	0.133	1.330	1.310	2.56	10
1 ¼"	35	1.660	1.335	0.140	1.677	1.655	3.15	10
1 ½"	41	1.900	1.564	0.145	1.918	1.894	3.15	10
2"	53	2.375	2.021	0.154	2.393	2.369	3.15	10
2 ½"	63	2.875	2.414	0.203	2.890	2.868	3.15	10
3"	78	3.500	3.008	0.216	3.515	3.492	3.94	10
3 ½"	91	4.000	3.486	0.226	4.015	3.992	3.94	10
4"	103	4.500	3.961	0.237	4.515	4.491	3.94	10
5"	129	5.563	4.975	0.258	5.593	5.553	3.94	10
6"	155	6.625	5.986	0.280	6.658	6.614	5.90	10